

Lok-it! HTI 1500 W/60/P50

Lok-it! Metal Halide



Areas of application

- Concert Lighting
- Club & Disco
- Stage & Theatre
- Studio, TV, & Film
- Architecture & Architainment

Product features and benefits

- Compact design and short arc gap allows for smaller and brighter fixtures
- Fast lamp replacement with one-touch rotate and lock base and socket design
- Robust design with eXtreme Seal (XS) technology, allowing up to 450°C at the pinch seal
- Consistent lumen output over the life of the lamp
- Improved ceramic base allows high voltage up to 35kV
- Higher luminous efficacy than conventional HID lamps provides higher fixture efficiency



Product datasheet

Technical data

General Product Information

Product number (Americas)	54225
Product name (Americas)	LOK-IT HTI 1500W/60/P50 1/CS 1/SKU
Family brand	Lok-it!
Lamp type	SINGLE END
Global order reference	Lok-it! HTI 1500 W/60/P50

Electrical Data

Nominal wattage	1500 W
Nominal voltage	100 V
Nominal current	15 A

Photometric Data

Nominal luminous flux	130000 lm
Color temperature	6000 K
Color rendering index Ra	>85
Light center length (LCL)	65.0 mm

Physical Attributes & Dimensions

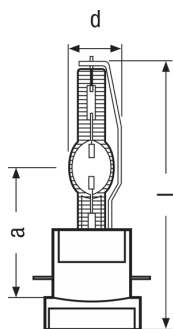

Electrode gap (cold)	6.1 mm
Lamp base	-
Diameter	29.0 mm
Diameter	29.0 mm
Length	128.0 mm
Product weight	100.00 g

Operating Conditions

Product datasheet

Burning position	Other
-------------------------	-------

Lifetime Data

Nominal lifetime	750 hr
-------------------------	--------

Environmental & Regulatory Information

Information according Art. 33 of EU Regulation (EC) 1907/2006 (REACH)	
Primary article identifier	4008321553416 4052899561823
Declaration no. in SCIP database	No declarable substances contained
Candidate list substance 1	No declarable substances contained

Product datasheet

Safety advice

Because of their high luminance, UV radiation and high internal pressure during operation, Lok-it! lamps may only be operated in enclosed lamp casings specially constructed for the purpose. Appropriate filters must ensure that UV radiation is reduced to an acceptable level. Mercury is released if the lamp breaks. Special safety precautions must be taken. Information on safety and handling is available on request or can be found in the leaflet included with the lamp or in the operating instructions.

Logistical Data

Product code	Product description	Packaging unit (Pieces/Unit)	Dimensions (length x width x height)	Volume	Gross weight
4008321553416	Lok-it! HTI 1500 W/60/P50	Shipping carton box 1	115 mm x 82 mm x 305 mm	2.88 dm ³	249.00 g
4062172308199	Lok-it! HTI 1500 W/60/P50		- x - x -		

The mentioned product code describes the smallest quantity unit which can be ordered. One shipping unit can contain one or more single products. When placing an order, for the quantity please enter single or multiples of a shipping unit.

Disclaimer

Subject to change without notice. Errors and omission excepted. Always make sure to use the most recent release.
