

PrevaLED Core G7 Food

Spot-, Down- and Wallmount Light Engines and Modules



Product family features

- Complete portfolio with varying luminous flux, color temperature, color rendering
- Lifetime (L80/B10): 60,000 h (temperature at $T_p = 65\text{ °C}$)
- LED module is basic isolated to mounting surface
- Photobiological safety according to IEC/TR 62778, risk group RG1
- Max. working voltage: 60 V (to be operated only on SELV LED control gear)

Product family benefits

- Easy integration thanks to very compact form factor
- Easy cooling due to optimized efficiency and high maximum operation temperature
- High driver flexibility allows cost-effective and intelligent systems
- 5 year guarantee

Areas of application

- Excellent light for FOOD applications
- Spotlighting in shops and retail
- Down- and wall lighting in offices, corridors, meeting rooms, workplaces
- Decorative and functional lighting in hospitality, hotels, restaurants
- Functional lighting in public and commercial buildings



Product family datasheet

Technical data

Product description	Electrical data					Photometrical data
	Nominal voltage	Type of current	Nominal current	On-mode power	Energy consumption in on-mode	Luminous efficacy
PL-CORE-G7 3000-927 L15 H1 ¹⁾	36.1 V	DC	0.749 A	27.1 W	27.1 kWh/1000h	111 lm/W
PL-CORE-G7 2000-927 L15 H1 ¹⁾	34.9 V	DC	0.465 A	15.9 W	15.9 kWh/1000h	123 lm/W
PL-CORE-G7 3000-S35 L15 H1 ¹⁾	35.0 V	DC	0.78 A	27.1 W	27.1 kWh/1000h	110 lm/W
PL-CORE-G7 3000-S65 L15 H1 ¹⁾	34.8 V	DC	0.55 A	18.7 W	18.7 kWh/1000h	158 lm/W
PL-CORE-G7 2000-S65 L15 H1 ¹⁾	34.1 V	DC	0.35 A	11.9 W	11.9 kWh/1000h	168 lm/W
PL-CORE-G7 3000-S40 L15 H1 ¹⁾	36.0 V	DC	1.33 A			63 lm/W

Product description	Light technical data				Starting time
	Color rendering index Ra	Correlated color temperature CCT	Colour consistency (McAdam ellipses)	Useful luminous flux (Φ_{use})	
PL-CORE-G7 3000-927 L15 H1 ¹⁾	≥ 90	2700 K	3	2349 lm ²⁾	0.0 s
PL-CORE-G7 2000-927 L15 H1 ¹⁾	≥ 90	2700 K	3	1507 lm ²⁾	0.0 s
PL-CORE-G7 3000-S35 L15 H1 ¹⁾	80	3500 K	3	2446 lm ²⁾	0.0 s
PL-CORE-G7 3000-S65 L15 H1 ¹⁾	80	6500 K	3	2268 lm ²⁾	0.0 s
PL-CORE-G7 2000-S65 L15 H1 ¹⁾	80	6500 K	3	1492 lm ²⁾	0.0 s
PL-CORE-G7 3000-S40 L15 H1 ¹⁾					0.0 s

Product description	Warm-up time (60 %)	Dimensions & weight		
		Product weight	Height	Length
PL-CORE-G7 3000-927 L15 H1 ¹⁾	0.00 s	6.00 g	3 mm	44 mm
PL-CORE-G7 2000-927 L15 H1 ¹⁾	0.00 s	6.00 g	3 mm	44 mm
PL-CORE-G7 3000-S35 L15 H1 ¹⁾	0.00 s	6.00 g	3 mm	44 mm
PL-CORE-G7 3000-S65 L15 H1 ¹⁾	0.00 s	6.00 g	3 mm	44 mm
PL-CORE-G7 2000-S65 L15 H1 ¹⁾	0.00 s	6.00 g	3 mm	44 mm
PL-CORE-G7 3000-S40 L15 H1 ¹⁾	0.00 s	6.00 g		

Product description	Width	Temperatures & operating conditions		
		Performance temp. acc. to IEC 62717	Maximum temperature at tc test point	Ambient temperature range
PL-CORE-G7 3000-927 L15 H1 ¹⁾	44 mm	65 °C	100 °C	-20...+50 °C
PL-CORE-G7 2000-927 L15 H1 ¹⁾	44 mm	65 °C	100 °C	-20...+50 °C

Product family datasheet

Product description	Width	Temperatures & operating conditions		
		Performance temp. acc. to IEC 62717	Maximum temperature at tc test point	Ambient temperature range
PL-CORE-G7 3000-S35 L15 H1 ¹⁾	44 mm	65 °C	100 °C	-20...+50 °C
PL-CORE-G7 3000-S65 L15 H1 ¹⁾	44 mm	65 °C	100 °C	-20...+50 °C
PL-CORE-G7 2000-S65 L15 H1 ¹⁾	44 mm	65 °C	100 °C	-20...+50 °C
PL-CORE-G7 3000-S40 L15 H1 ¹⁾		65 °C	100 °C	-20...+50 °C

Product description	Temperature range at storage	Lifespan		Certificates & standards
		Number of switching cycles	Lumen maintenance factor LMF	Standards
PL-CORE-G7 3000-927 L15 H1 ¹⁾	-20...60 °C	100000	96	CE/ENEC
PL-CORE-G7 2000-927 L15 H1 ¹⁾	-20...60 °C	100000	96	CE/ENEC
PL-CORE-G7 3000-S35 L15 H1 ¹⁾	-20...60 °C	100000	96	CE/ENEC
PL-CORE-G7 3000-S65 L15 H1 ¹⁾	-20...60 °C	100000	96	CE/ENEC
PL-CORE-G7 2000-S65 L15 H1 ¹⁾	-20...60 °C	100000	96	CE/ENEC
PL-CORE-G7 3000-S40 L15 H1 ¹⁾	-20...60 °C	100000		CE/ENEC

Product description	Energy efficiency class	Logistical data	Environmental information Information according Art. 33 of EU Regulation (EC) 1907/2006 (REACH)	
		Commodity code	Date of Declaration	Primary Article Identifier
PL-CORE-G7 3000-927 L15 H1 ¹⁾	F	854141000000	18-04-2022	4052899534544
PL-CORE-G7 2000-927 L15 H1 ¹⁾	F	854141000000	18-04-2022	4052899534384
PL-CORE-G7 3000-S35 L15 H1 ¹⁾	F	854141000000	18-04-2022	4052899576582
PL-CORE-G7 3000-S65 L15 H1 ¹⁾	E	854141000000	18-04-2022	4052899576667
PL-CORE-G7 2000-S65 L15 H1 ¹⁾	D	854141000000	18-04-2022	4052899576629
PL-CORE-G7 3000-S40 L15 H1 ¹⁾		854141000000	18-04-2022	4052899576568

Product description	Candidate List Substance 1	Declaration No. in SCIP database
PL-CORE-G7 3000-927 L15 H1 ¹⁾	No declarable substances contained	No declarable substances contained
PL-CORE-G7 2000-927 L15 H1 ¹⁾	No declarable substances contained	No declarable substances contained
PL-CORE-G7 3000-S35 L15 H1 ¹⁾	No declarable substances contained	No declarable substances contained
PL-CORE-G7 3000-S65 L15 H1 ¹⁾	No declarable substances contained	No declarable substances contained
PL-CORE-G7 2000-S65 L15 H1 ¹⁾	No declarable substances contained	No declarable substances contained
PL-CORE-G7 3000-S40 L15 H1 ¹⁾	No declarable substances contained	No declarable substances contained

¹⁾ Modules perfectly matched to OSRAM OPTOTRONIC LED drivers (see relevant table)/For current photometric data and important safety, installation and application information (see www.osram.com/led-systems/), All the technical parameters apply to the entire module. In view of the complex manufacturing process for light emitting diodes, the typical values given above for the technical LED parameters are merely statistical values that do not necessarily correspond to the actual technical parameters of an individual product; individual products may vary from the typical values/Tolerance for optical and electrical data: +/-10%/OSRAM is not liable for errors in luminaires design and assembly

Product family datasheet

²⁾ 120°

Product family datasheet

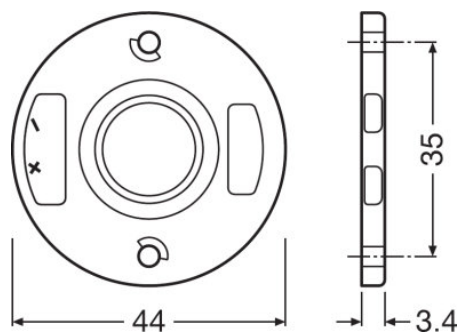

PL-CORE-G7 3000







Application advice

For more detailed application information and graphics please see product datasheet.

Sales and Technical Support

Sales and Technical Support www.osram.com

Download Data

File	
	Addon Technical Information PrevaLED Core G7 Overview
	Certificates ENEC Certificate PL CORE G7
	Declarations of conformity PL CORE G7 CE 3610978 150322
	CAD data PL CORE G7 L15 H1 IGS 150520
	CAD data PL CORE G7 L15 H1 STEP 150520
	CAD Data 2-dim PL CORE G7 L15 H1 CAD2PDF 150520
	CAD data 3-dim PL CORE G7 L15 H1 CAD3PDF 150520

Product family datasheet

Ecodesign regulation information:

Separate control gear and light sources must be disposed of at certified disposal companies in accordance with Directive 2012/19/EU (WEEE) in the EU and with Waste Electrical and Electronic Equipment (WEEE) Regulations 2013 in the UK. For this purpose, collection points for recycling centres and take-back systems (CRSO) are available from retailers or private disposal companies, which accept separate control gear and light sources free of charge. In this way, raw materials are conserved and materials are recycled.

Logistical Data

Product code	Product description	Packaging unit (Pieces/Unit)	Dimensions (length x width x height)	Volume	Gross weight
4052899534544	PL-CORE-G7 3000-927 L15 H1	Shipping carton box 40	375 mm x 263 mm x 38 mm	3.75 dm ³	807.00 g
4052899534384	PL-CORE-G7 2000-927 L15 H1	Shipping carton box 40	375 mm x 263 mm x 38 mm	3.75 dm ³	807.00 g
4052899576582	PL-CORE-G7 3000-S35 L15 H1	Shipping carton box 40	375 mm x 263 mm x 38 mm	3.75 dm ³	807.00 g
4052899576667	PL-CORE-G7 3000-S65 L15 H1	Shipping carton box 40	375 mm x 263 mm x 38 mm	3.75 dm ³	807.00 g
4052899576629	PL-CORE-G7 2000-S65 L15 H1	Shipping carton box 40	375 mm x 263 mm x 38 mm	3.75 dm ³	807.00 g
4052899576568	PL-CORE-G7 3000-S40 L15 H1	Shipping carton box 40	375 mm x 263 mm x 38 mm	3.75 dm ³	807.00 g

The mentioned product code describes the smallest quantity unit which can be ordered. One shipping unit can contain one or more single products. When placing an order, for the quantity please enter single or multiples of a shipping unit.

References / Links

For Guarantee see

▶ www.osram.com/guarantee

Disclaimer

Subject to change without notice. Errors and omission excepted. Always make sure to use the most recent release.