

PrevaLED Core G7 Fashion

Spot-, Down- and Wallmount Light Engines and Modules



Areas of application

- Excellent light for FASHION applications
- Spotlighting in shops and retail
- Down- and wall lighting in offices, corridors, meeting rooms, workplaces
- Decorative and functional lighting in hospitality, hotels, restaurants
- Functional lighting in public and commercial buildings

Product family benefits

- Easy integration thanks to very compact form factor
- Easy cooling due to optimized efficiency and high maximum operation temperature
- High driver flexibility allows cost-effective and intelligent systems
- 5 year guarantee

Product family features

- Complete portfolio with varying luminous flux, color temperature, color rendering
- LED module is basic isolated to mounting surface
- Photobiological safety according to IEC/TR 62778, risk group RG1
- Max. working voltage: 60 V (to be operated only on SELV LED control gear)



Product family datasheet

Technical data

Electrical data

Product description	Nominal voltage	Type of current	Nominal current
PL-CORE-G7 3000-S35 L15 H1 ¹⁾	35.0 V	DC	0.78 A

¹⁾ See product remark

Photometrical data

Product description	Luminous efficacy	Color rendering index Ra
PL-CORE-G7 3000-S35 L15 H1 ¹⁾	110 lm/W	80

¹⁾ See product remark

Light technical data

Product description	Starting time	Warm-up time (60 %)	Beam angle
PL-CORE-G7 3000-S35 L15 H1 ¹⁾	0.0 s	0.00 s	114.60 °

¹⁾ See product remark

Dimensions & weight

Product description	Product weight	Height	Width	Length
PL-CORE-G7 3000-S35 L15 H1 ¹⁾	6.00 g	3.0 mm	44.0 mm	44.0 mm

¹⁾ See product remark

Product line drawing

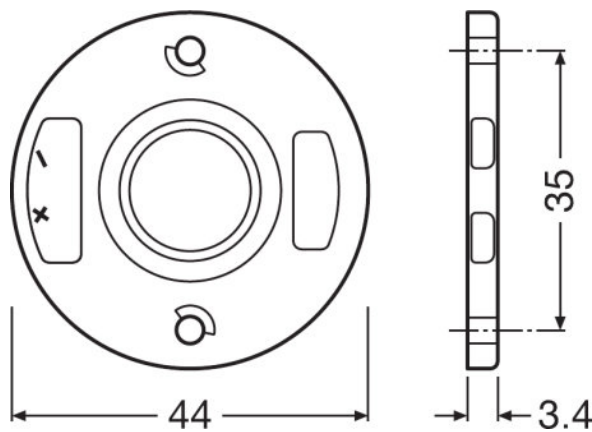

PL-CORE-G7 3000-S35 L15 H1

Temperatures & operating conditions

Product description	Performance temp. acc. to IEC 62717	Maximum temperature at tc test point	Ambient temperature range	Temperature range at storage
PL-CORE-G7 3000-S35 L15 H1 ¹⁾	65 °C	100 °C	-20...+50 °C	-20...60 °C

¹⁾ See product remark

Lifespan

Product description	Number of switching cycles	L70B50 lifetime
PL-CORE-G7 3000-S35 L15 H1 ¹⁾	100000	60000 h

¹⁾ See product remark

Additional product data

Product description	Lighting technology used
PL-CORE-G7 3000-S35 L15 H1 ¹⁾	LED

¹⁾ See product remark

Product family datasheet

Certificates & standards

Product description	Standards
PL-CORE-G7 3000-S35 L15 H1 ¹⁾	CE/ENEC

¹⁾ See product remark

Logistical data

Product description	Commodity code
PL-CORE-G7 3000-S35 L15 H1 ¹⁾	85414100000

¹⁾ See product remark

Environmental information
Information according Art. 33 of EU Regulation (EC) 1907/2006 (REACH)

Product description	Date of Declaration	Primary Article Identifier	Candidate List Substance 1
PL-CORE-G7 3000-S35 L15 H1 ¹⁾	30-03-2023	4052899576582	No declarable substances contained

Product description	Declaration No. in SCIP database
PL-CORE-G7 3000-S35 L15 H1 ¹⁾	No declarable substances contained

¹⁾ See product remark

Product remark

Modules perfectly matched to OSRAM OPTOTRONIC LED drivers (see relevant table)/For current photometric data and important safety, installation and application information (see www.osram.com/led-systems)./All the technical parameters apply to the entire module. In view of the complex manufacturing process for light emitting diodes, the typical values given above for the technical LED parameters are merely statistical values that do not necessarily correspond to the actual technical parameters of an individual product; individual products may vary from the typical values/Tolerance for optical and electrical data: +/-10%/OSRAM is not liable for errors in luminaires design and assembly

Application advice



For more detailed application information and graphics please see product datasheet.

Sales and Technical Support

Sales and Technical Support www.osram.com

Product family datasheet

Download Data

File	
	Addon Technical Information PrevaLED Core G7 Overview
	Certificates ENEC Certificate PL CORE G7

Ecodesign regulation information:

Separate control gear and light sources must be disposed of at certified disposal companies in accordance with Directive 2012/19/EU (WEEE) in the EU and with Waste Electrical and Electronic Equipment (WEEE) Regulations 2013 in the UK. For this purpose, collection points for recycling centres and take-back systems (CRSO) are available from retailers or private disposal companies, which accept separate control gear and light sources free of charge. In this way, raw materials are conserved and materials are recycled.

Logistical Data

Product code	Product description	Packaging unit (Pieces/Unit)	Dimensions (length x width x height)	Volume	Gross weight
4052899576582	PL-CORE-G7 3000-S35 L15 H1	Shipping carton box 40	375 mm x 263 mm x 38 mm	3.75 dm ³	807.00 g

The mentioned product code describes the smallest quantity unit which can be ordered. One shipping unit can contain one or more single products. When placing an order, for the quantity please enter single or multiples of a shipping unit.

References / Links

For Guarantee see <https://www.inventronics-light.com/multilevel-guarantees>

Disclaimer

Subject to change without notice. Errors and omission excepted. Always make sure to use the most recent release.