

PL-LIN ENDCAP for optic

PrevaLED Linear Optic 29 mm | – Accessories

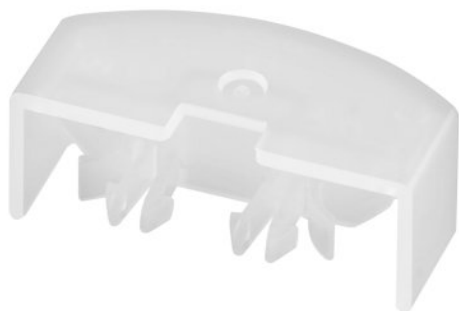

Product family features

- Full Width Half Maximum (FWHM) of 30°, 60° and 90°
- Available lengths: 600, 1,150 and 1,450 mm
- Linear lense out of PC material

Product family benefits

- Linear optic for PrevaLED Linear LED modules with 20 mm width
- Available with different beam angles
- Easy mounting by just snapping over M4 mounting screw heads

Areas of application

- Retail
- Industry

Product datasheet

Technical data

Dimensions & weight

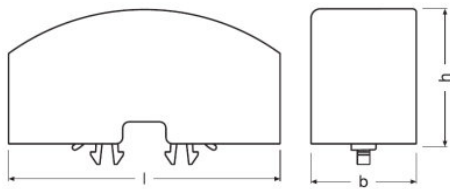

Product weight	2.10 g
Length	12.0 mm
Width	33.0 mm
Height	16.0 mm

Logistical data

Commodity code	39269097900
----------------	-------------

Environmental information

Information according Art. 33 of EU Regulation (EC) 1907/2006 (REACH)	
Date of Declaration	25-04-2022
Primary Article Identifier	4052899600102
Candidate List Substance 1	No declarable substances contained
Declaration No. in SCIP database	No declarable substances contained

Logistical Data

Product code	Product description	Packaging unit (Pieces/Unit)	Dimensions (length x width x height)	Volume	Gross weight
4052899600102	PL-LIN ENDCAP for optic	Shipping carton box 240	200 mm x 140 mm x 150 mm	4.20 dm ³	618.00 g

The mentioned product code describes the smallest quantity unit which can be ordered. One shipping unit can contain one or more single products. When placing an order, for the quantity please enter single or multiples of a shipping unit.

Disclaimer

Subject to change without notice. Errors and omission excepted. Always make sure to use the most recent release.