

FX-LFDM -G1-BS-12H13

LINEARlight FLEX Diffuse Profile System | Accessories for Flexible LED strips

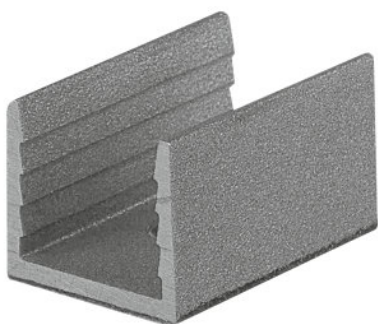

Product family features

- Compatible with all LINEARlight Flex DIFFUSE LED modules
- Different combinations for a huge variety of mounting needs
- Clips and profiles ideal for confined spaces
- Bendable profile available
- Easy application

Product family benefits

- Plenty of freedom for attractive design and perfect functioning
- Quick and easy installation
- Aluminum profile robust and corrosion-resistant thanks to anodization
- Minimum installation dimensions thanks to compact design

Areas of application

- Architectural Integration – e.g. coves, walls
- Ceiling integration
- Recessed lighting
- Cove lighting
- Shelf and furniture lighting

Product datasheet

Technical data

Dimensions & weight

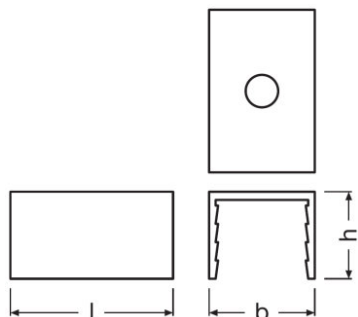

Product weight	2.40 g
Length	20.0 mm
Width	13.1 mm
Height	12.0 mm

Logistical data

Commodity code	761699909900
----------------	--------------

Environmental information

Information according Art. 33 of EU Regulation (EC) 1907/2006 (REACH)	
Date of Declaration	30-08-2022
Primary Article Identifier	4052899452541
Candidate List Substance 1	No declarable substances contained
Declaration No. in SCIP database	No declarable substances contained

Download Data

File	
	User instruction LINEARLIGHT Flex Diffuse Installation Guide - Naed Version (EN)

Product datasheet

Logistical Data

Product code	Product description	Packaging unit (Pieces/Unit)	Dimensions (length x width x height)	Volume	Gross weight
4052899452541	FX-LFDM -G1-BS-12H13	Shipping carton box 400	230 mm x 180 mm x 160 mm	6.62 dm ³	2784.00 g

The mentioned product code describes the smallest quantity unit which can be ordered. One shipping unit can contain one or more single products. When placing an order, for the quantity please enter single or multiples of a shipping unit.

Disclaimer

Subject to change without notice. Errors and omission excepted. Always make sure to use the most recent release.