

## QBM D4i LS/PD HB Z

Qualified Bluetooth mesh D4i Module | Light management systems



### Product family features

- With/without Daylight and Occupancy Sensor DEXAL Module
- Qualified Bluetooth mesh enabled by Silvair
- Control of DEXAL drivers or DALI drivers with additional DALI bus power supply
- Intended for installation into a standard ½" knockout
- Works with OSRAM Hubsense
- Works with OSRAM DEXAL

### Product family benefits

- Design freedom due to compact size
- Easy to integrate in luminaire
- Minimize internal wiring in combination with DEXAL drivers
- Secured product communication granted by ioXT and PSA Certificates

### Areas of application

- Open offices
- Individual offices
- Conference rooms
- Classrooms
- Storage and break areas
- Stairways
- Toilets

Technical data

Electrical data

|                                 |   |
|---------------------------------|---|
| Input voltage DC                | 12...22.5 V                                 |
| Peak input current              | 30 mA                                       |
| Average input current           | 10 mA                                       |
| Radio frequency                 | 2.4 GHz                                     |
| Maximum TX power                | +4 dBm                                      |
| Wireless protocol               | Qualified Bluetooth mesh enabled by Silvair |
| Wireless range                  | 12 m line of sight                          |
| System wattage                  | 0.30 W                                      |
| Standby power                   | < 150 mW                                    |
| Screw thread length             | 25 mm                                       |
| Required DALI current (typical) | 10 mA                                       |
| Peak DALI current               | 30 mA                                       |
| Maximum start-up time (DALI)    | -   |

Dimensions & weight

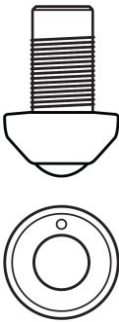
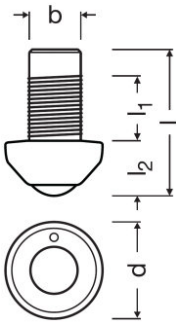

|                                     |                             |
|-------------------------------------|-----------------------------|
| Length                              | 43.5 mm                     |
| Diameter                            | 37.0 mm                     |
| Mounting hole diameter              | 22.2...23.2 mm              |
| Product weight                      | 18.20 g                     |
| Wire preparation length, input side | 7...9 mm                    |
| Cable cross-section, output side    | -                           |
| Cable cross-section, input side     | 0.25...0.75 mm <sup>2</sup> |
| Maximum allowed cable length        | 10                          |
| Screw thread length                 | 25 mm                       |

Temperatures & operating conditions

Product datasheet

|  |              |
|--|--------------|
| Ambient temperature range                | -20...+50 °C |
| Permitted rel. humidity during operation | 0...90 %     |
| Temperature range at storage             | 0...70 °C    |
| Permitted relative humidity at storage   | 0...95 %     |
| Maximum temperature at tc test point     | 60 °C        |

Lifespan

|          |         |
|----------|---------|
| Lifespan | 50000 h |
|----------|---------|

Capabilities

|                                |  |
|--------------------------------|--|
| Control output                 | D4i  |
| Number of connected drivers    | 4  |
| Dimmable                       | Yes  |
| Type of sensor                 | Daylight / PIR                                     |
| Operating range, light sensor  | <1000 lx   |
| Detection angle                | 90 °   |
| Maximum installation height    | -  |
| Compatibility                  | Works with OSRAM HubSense / Works with OSRAM DEXAL |
| Status Indicator               | Green: network Status / Red: Motion detected       |
| Reset                          | Magnetic <sup>1)</sup>                             |
| Number of control outputs      | -  |
| Dimming interface              | D4i  |
| Type of installation           | Luminaire integration                              |
| Control interface              | qualified Bluetooth mesh                           |
| Detection angle (Light sensor) | +/- 15°  |
| Detection angle (PIR)          | +/-60°   |

<sup>1)</sup> by magnet

Certificates & standards

|                           |          |
|---------------------------|----------|
| Approval marks – approval | CE / D4i |
| Type of protection        | IP54     |

Logistical data

|                |             |
|----------------|-------------|
| Commodity code | 90314990000 |
|----------------|-------------|

Environmental information

|   |            |
|---|------------|
| Information according Art. 33 of EU Regulation (EC) 1907/2006 (REACH) |            |
| Date of Declaration   | 25-05-2023 |

Product datasheet

|                                  |               |
|----------------------------------|---------------|
| Primary Article Identifier       | 4062172310284 |
| Declaration No. in SCIP database | In work       |

Additional product information

- By integrating the device into a casing the wireless range could be affected, in particular by metal surfaces. Therefore, the wireless range needs to be verified after integration.
- The device could be reset to factory default by placing a strong Neodym magnet (e.g. N35, d=6.35 mm x h=1.59 mm) near the corner of the bezel for 5 seconds.
- The status LED of the device indicates following Network status. Fast blinking (Blue): Not connected to a network, Slow blinking (Blue); Connected to a network, Blink twice (Blue): Mesh package received, Long blink (Blue) Factory reset, Blink one (Red): Motion detected
- The device has passed successfully the SILVAIR Testing process.
- The device can be put into operation using the OSRAM HubSense Commissioning Tool (<https://platform.hubsense.eu>), subject to prior acceptance of the Terms of Use and the Privacy Policy.
- OSRAM may terminate or suspend the use of the HubSense Commissioning Tool at any time and for any or no reason in its sole discretion, even if access and use is continued to be allowed to others.
- The device complies with Bluetooth mesh Standard v1.0. It can also be used in 3rd party Bluetooth mesh network, that complies with this standard and that supports the mesh models of this device, and with certain 3rd party commissioning tools, that support the mesh models of this device. In order to ensure correct interoperability a verification with the 3rd party network components and the 3rd party commissioning tool is necessary in advance. Please contact OSRAM ([support@hubsense.eu](mailto:support@hubsense.eu)) to receive the actual list of supported models for this device.
- OSRAM shall have no liability for any 3rd party commissioning tool and does not make any representations, express or implied, about the availability and/or performance of such commissioning tool.
- OSRAM shall have no liability for and does not make any representations, express or implied, about the connectivity of OSRAM QBM products with any other products, that have passed the SILVAIR Testing process.

Logistical Data

| Product code  | Product description | Packaging unit (Pieces/Unit) | Dimensions (length x width x height) | Volume                | Gross weight |
|---------------|---------------------|------------------------------|--------------------------------------|-----------------------|--------------|
| 4062172310284 | QBM D4i LS/PD HB Z  | Shipping carton box<br>50    | 330 mm x 287 mm x 195 mm             | 18.47 dm <sup>3</sup> | 1530.00 g    |

The mentioned product code describes the smallest quantity unit which can be ordered. One shipping unit can contain one or more single products. When placing an order, for the quantity please enter single or multiples of a shipping unit.

Disclaimer

Subject to change without notice. Errors and omission excepted. Always make sure to use the most recent release.